

Check for signs of Sudden Cardiac Arrest: Unresponsive
 Not Breathing Normally

1 PULL

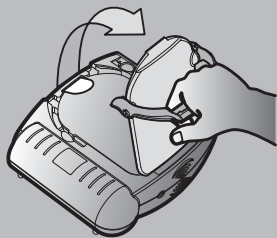

2 PLACE

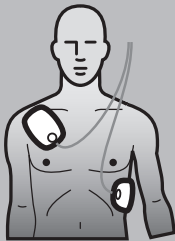

3 PRESS

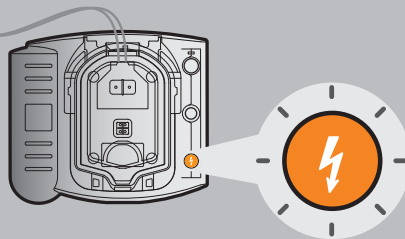

QUICK REFERENCE GUIDE

DETAILED INSTRUCTIONS

To start: Pull handle. Remove protective cover.

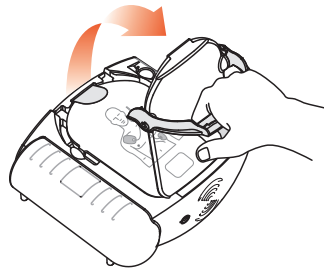
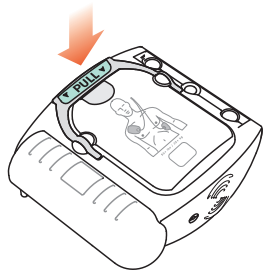

1

Remove all clothes from victim's chest.
Clean and dry skin, if needed.

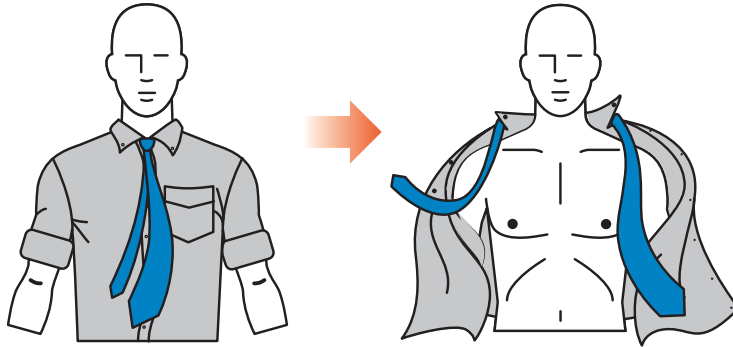

Peel off film seal and remove pads.

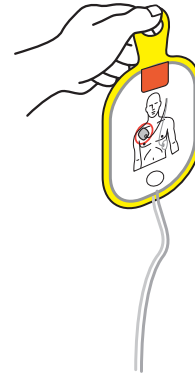
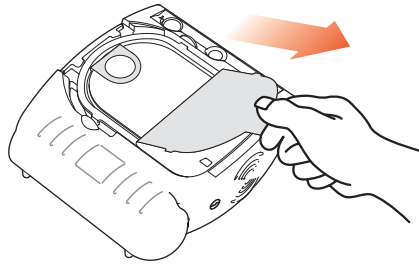

3

Peel each pad from yellow plastic liner.

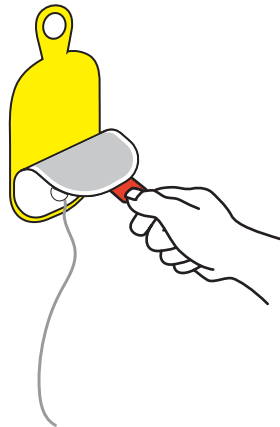
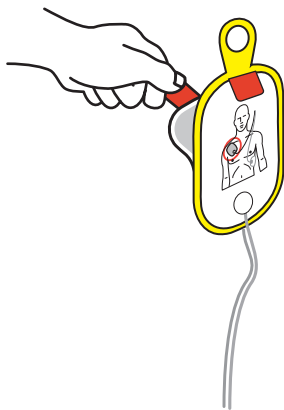

Place pads exactly as shown in the picture.

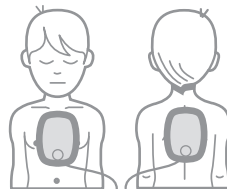
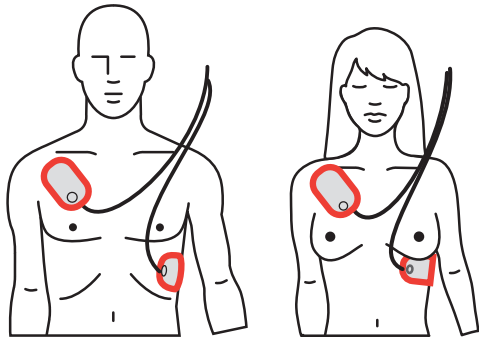

(0-8 YEARS) < 55 lbs/25 kg

Analyzing ... Do not touch the patient!

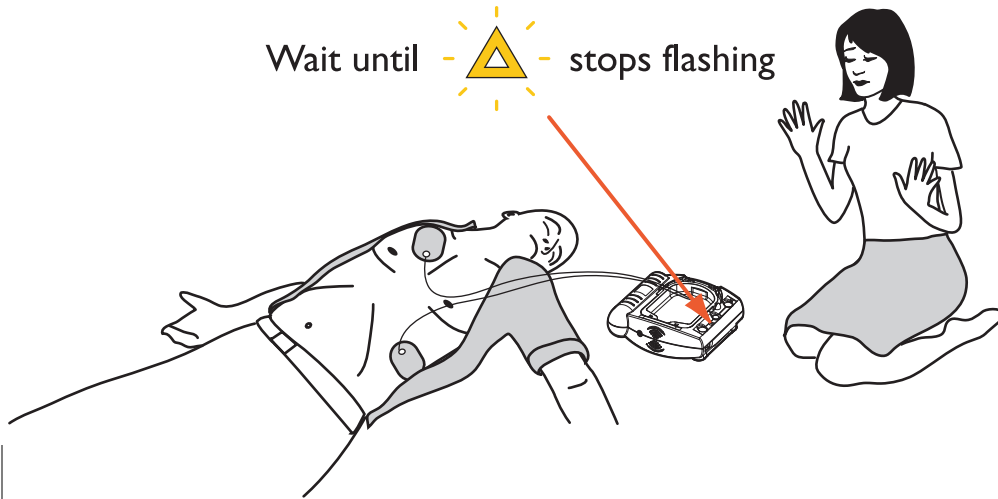

To shock: Press flashing **ORANGE** shock button.
Do not touch patient.

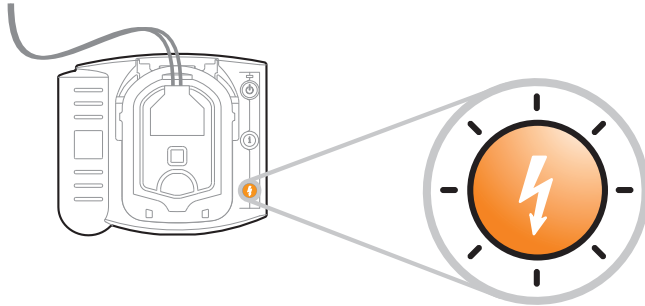

To get help with CPR: Press flashing **BLUE** button.

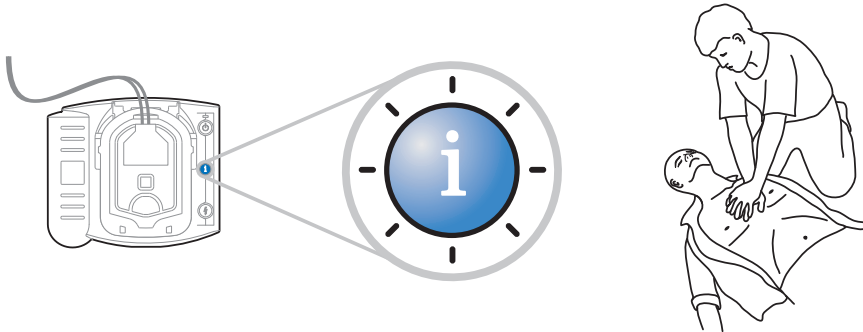

30 compressions • Pinch nose, tilt head • 2 full breaths

To turn ON: Press **GREEN** on/off button.

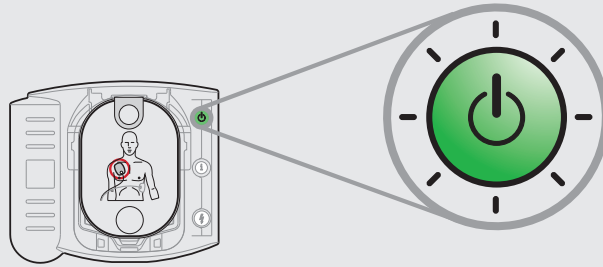

If cartridge needs to be replaced: Slide latch.

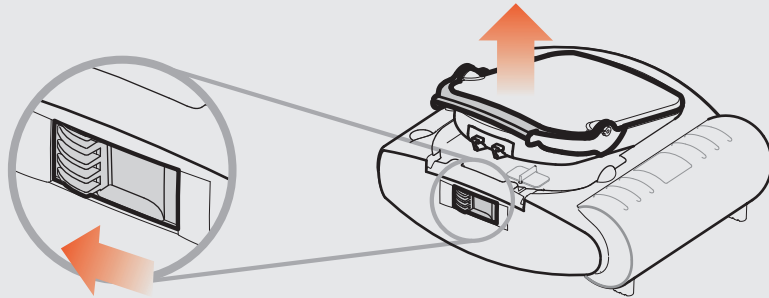

Printed in USA

Philips Medical Systems
Bothell, WA 98021-8431, USA

Copyright © 2010
Philips Electronics North American Corp

453564141542 REV III

REF M5066-97800



453564141542

PHILIPS